

5.71

PIPER

BENCH MARK
DRILL HOLE
IN KERB
RL 5.90 (AHD)

CL

6.34 6.39



Lot 604

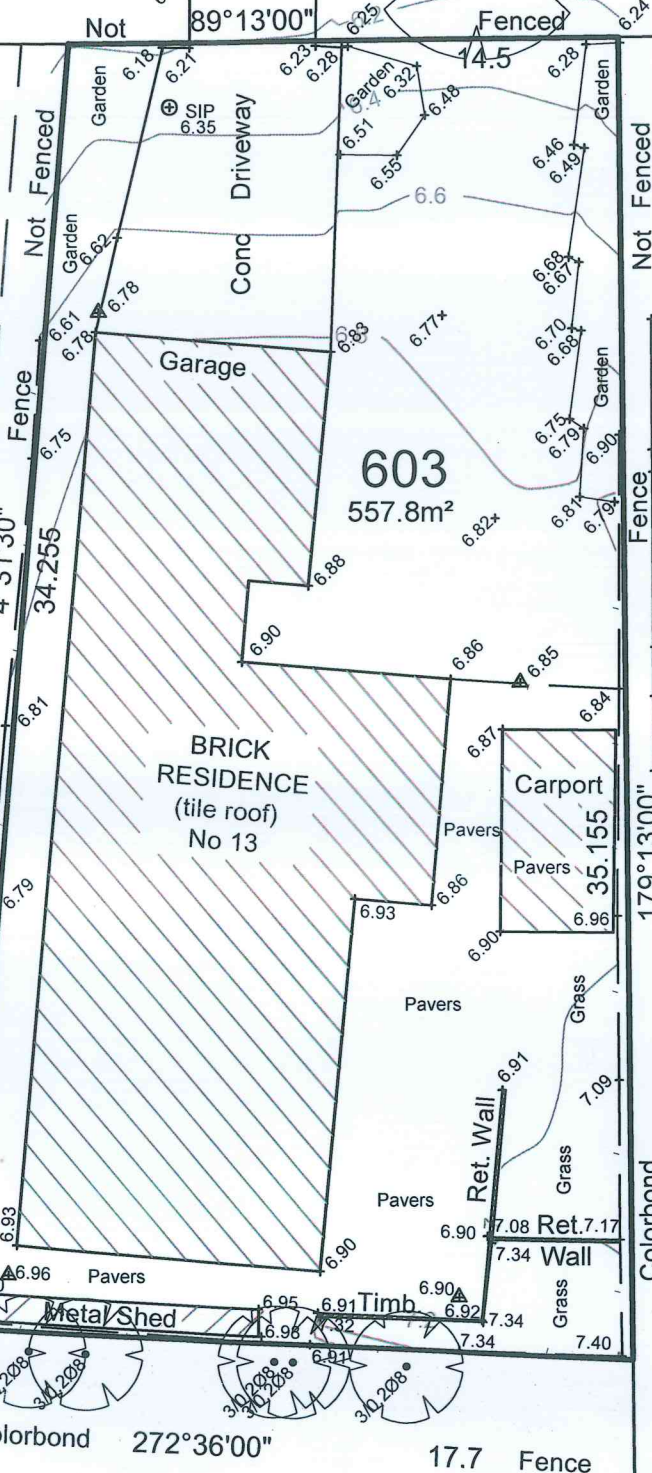
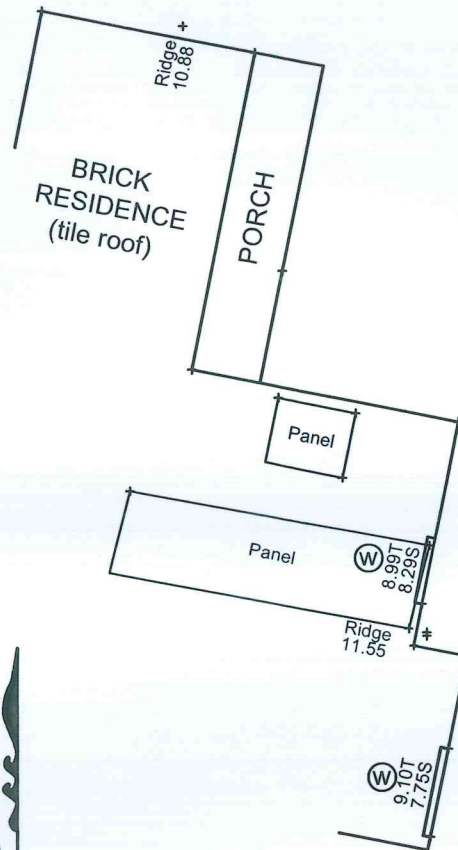

Lot 419
DP 261032

1 & 2 STY
BRICK
RESIDENCE
(tile roof)

Ⓐ EASEMENT TO DRAIN WATER 1.25 WIDE

Ⓓ Denotes Door
Ⓜ Denotes Window

KEY

ET : Electric Turret	Ⓛ	LIN : Lintel	
LP : Light Pole	Ⓚ	KO : Kerb Outlet	+
PP : Power Pole	Ⓢ	SIP : Sewer Insp Point	Ⓢ
GAS : Gas Meter	Ⓜ	SMS : Sewer Maint. Shaft	Ⓜ
HYD : Hydrant	Ⓜ	SMH : Sewer Manhole	Ⓜ
SV : Stop Valve	Ⓢ	TEL : Telecom Pit	Ⓢ
WC : Water Connection	Ⓢ	PC : Pram Crossing	
WM : Water Meter	Ⓜ	VC : Vehicle Crossing	
SWP : Stormwater Pit	Ⓢ	DH&W: Drillhole & Wing	Ⓢ

I, S.T. DIKE #924
of burton & field Pty. limited, surveyor registered under
the surveying and spatial information act 2002

burton & field Pty. limited A.C.N. 002 093 432

Lot 418
DP 261032

1 & 2 STY
BRICK
RESIDENCE
(tile roof)

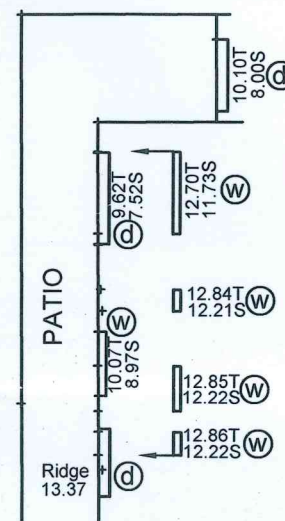

NOTES 1 :-

- 1) This survey has been carried out in accordance with Clause (9) of the Surveying & Spatial Information Regulation 2017.
- 2) Bearings, Area & Distances are by Title and / or deeds only. No boundary investigation has been carried out.
- 3) Relationship of improvements to boundaries is diagrammatic only. Where offsets are critical they should be confirmed by further survey.
- 4) Contours shown depict the topography. Except at spot levels shown they do not necessarily represent the exact level at any particular point.
- 5) Services shown hereon have been determined from visual evidence only. Prior to any design, demolition, excavation or construction on site the relevant authority should be contacted to establish detailed location and depth.
- 6) These notes form an integral part of this plan & should not be separated.
- 7) Location of sewer subject to confirmation from Sydney Water or relevant authority.
- 8) The Symbols are not to scale and are indicative only
- 9) Tree dimensions are approximate only, shown as 15(spreadØ) 0.5 (trunkØ) & 12(height).
- 10) Australian Height Datum (AHD) was established from SSM 180349, RL 7.387, Source - SCIMS Survey Mark Report.
- 11) The bearings on these plan boundaries are from Land Titles Office plans. They are Magnetic Meridian. If accurate True North is required a further survey would be necessary.

CAUTION 1 :
INFORMATION CONTAINED IN THIS PLAN IS THE
COPYRIGHT OF BURTON AND FIELD PTY LIMITED.
THE USE, DUPLICATION (WHETHER IN PART OR FULL)
WITHOUT CONSENT OF BURTON AND FIELD PTY LIMITED
CONSTITUTES AN INFRINGEMENT OF COPYRIGHT.

BURTON & FIELD
surveying & land development

All Correspondence to:
343 Hume Highway, Liverpool, N.S.W. 2170
P.O.Box 242 Liverpool, N.S.W. 1871
Tel: (02) 9602-1199 Fax: (02) 9821-2620
Email: survey@burtonandfield.com.au

Suite 202, 2 Pembroke Street Epping, N.S.W. 2121
P.O.Box 1150, Epping, N.S.W. 1710
Tel: (02) 9868-4660 Fax: (02) 9868-6035
E-mail: epping.reception@burtonandfield.com.au
Web: www.burtonandfield.com.au

PROJECT:
**CONTOUR & DETAIL SURVEY FOR
LOT 603 IN DP 261034
13 PIPER CL., MILPERRA**

LGA: CANTERBURY ~ BANKSTOWN

COMP REF: J:\87911\...87911_C

REVISION

CLIENT: LOCAL POOLS & SPA

DATE: 21/05/2025 SCALE: 1:200 SHEET
REF: 35256/87911/1/JMK DATUM: AHD 1 of 1